

SPECIFICATION OF DIELECTRIC FILTER

TOKO P/No: TDFM1C-2450T-10

1. OUTLINE DIMENSION

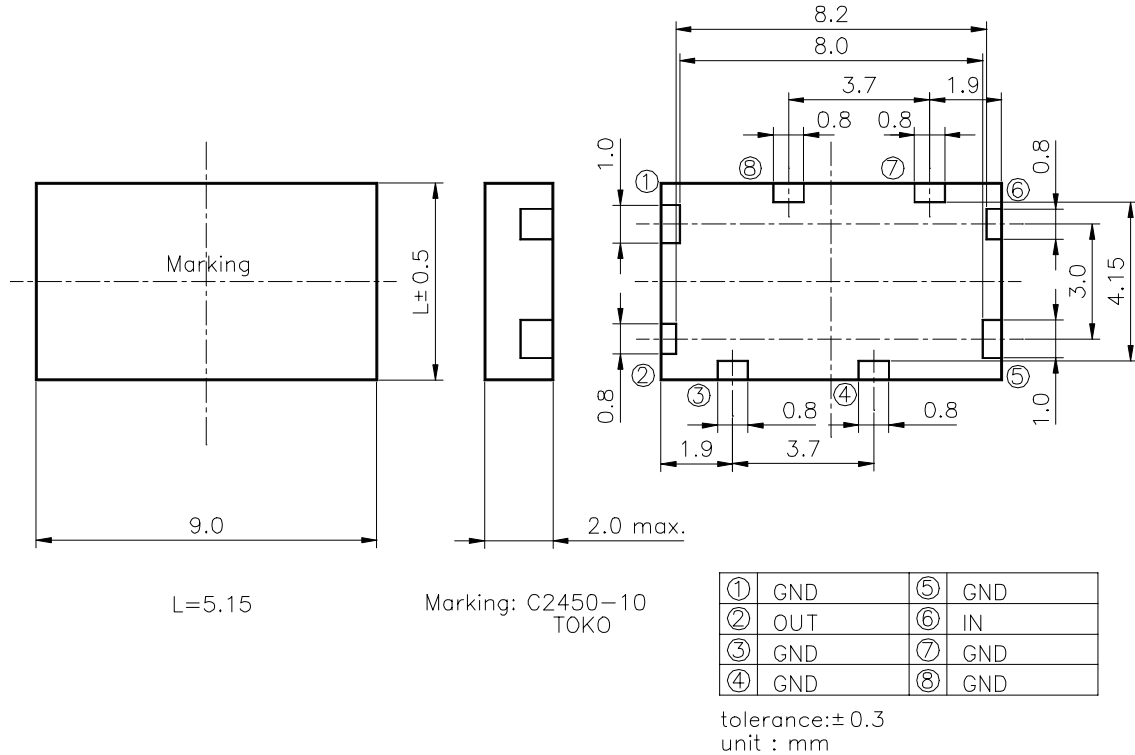

2. ELECTRICAL CHARACTERISTICS

SPECIFICATION (-20°C ~ +60°C)

CENTER FREQUENCY (Fo)	:	2450.0 MHz
PASS BAND WIDTH	:	$F_0 \pm 50.0$ MHz
INSERTION LOSS IN PASS BAND	:	3.0 dB max.
RIPPLE IN PASS BAND	:	1.0 dB max.
V.S.W.R. IN PASS BAND	:	2.0 max.
ATTENUATION		
	at 2250.0 MHz	: 32.0 dB min.
	at 2300.0 MHz	: 21.0 dB min.
	at 2600.0 MHz	: 21.0 dB min.
	at 2650.0 MHz	: 31.0 dB min.

IN/OUT IMPEDANCE : 50 ohm

(All specifications are an absolute value.)

PRECAUTION

Do not connect terminals to DC voltage.

Orig.	1998-5-22	y.yamada
Issues		Sig.

Test Data of Dielectric Filter

Toko No. : TDFM1C-2450T-10

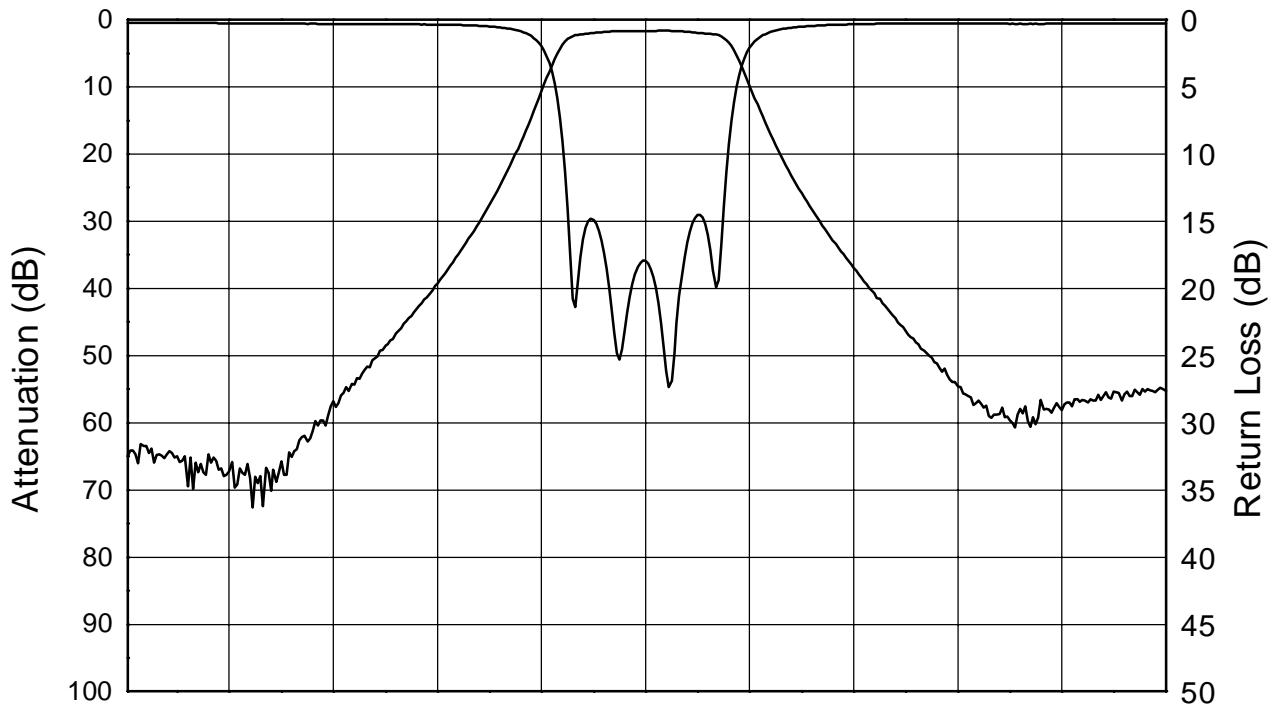

Center Frequency : 2,450.00MHz Span : 1,000.00MHz

Passband Insertion Loss	1.97 dB
Passband Ripple	0.35 dB
Passband V.S.W.R.	1.46
Attenuation	
At 2,250.00 MHz	38.68 dB
At 2,300.00 MHz	26.88 dB
At 2,600.00 MHz	26.44 dB
At 2,650.00 MHz	37.38 dB

Data : 98.02.24

Instrument : WILTRON 37225B

PCB Recommended Pattern For Dielectric Filter

TOKO P/No : TDFM1C-2450T-10

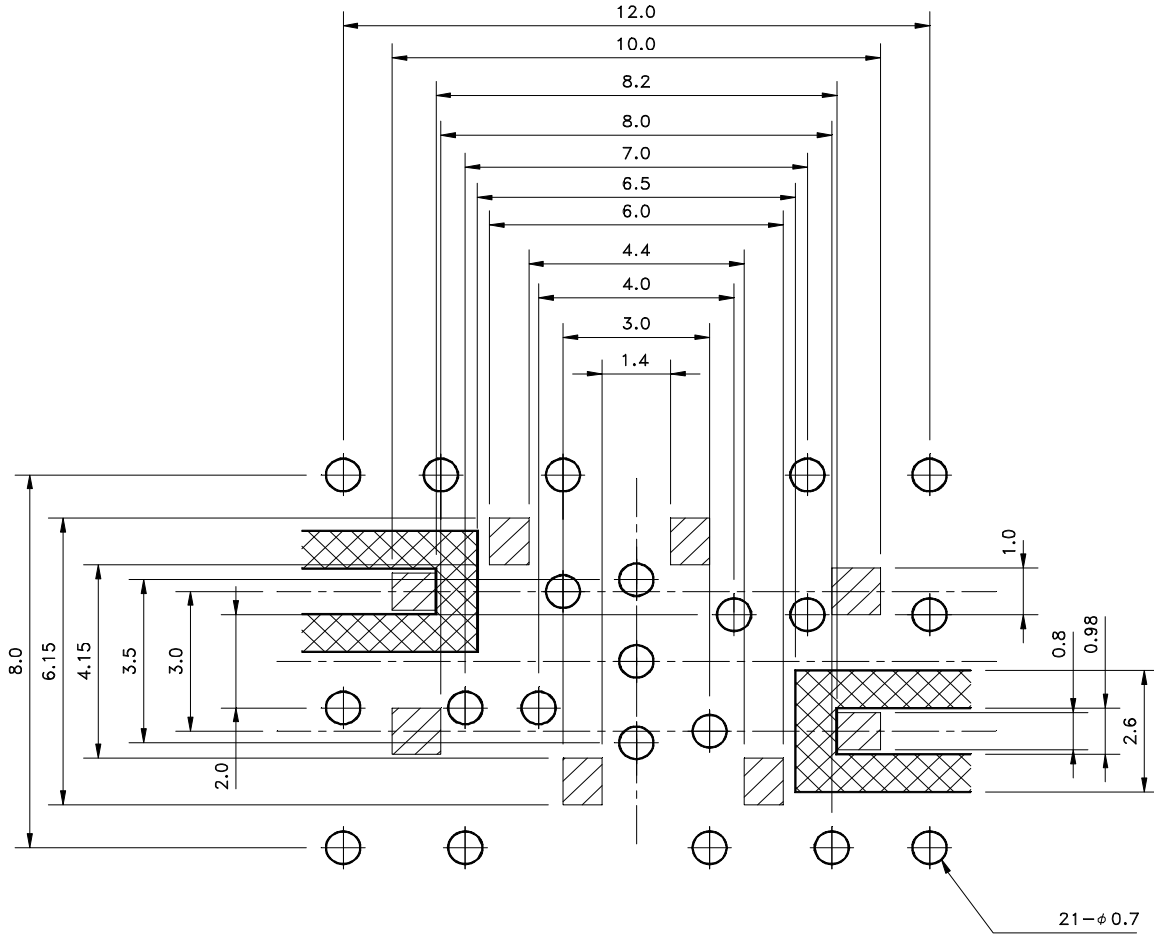

PARTS OF NOT COPPERED
(OTHER PARTS ARE COPPERED)



SOLDERING PARTS

SUBSTRATE MATERIAL

BT RESIN CCL-H870 t=0.4mm

CCL-H870's typical dielectric constant is 3.6 at 1GHz.

CAUTION

Do not connect terminals to DC voltage.